

## INDUSTRIAL PRESSURE GAUGE

### Model : AG54 (Dry) / AG55 (Oil Filled)

AG54 (Dry) & AG55 (Oil Filled) with crimp casing models are designed for corrosive environment which do corrode copper alloy and not highly viscosity or do not crystallize. Systems or equipment with pulsating pressure & vibration are apparent, the oil filled model is recommended.



### Standard Specification

#### Dial Size ( Nominal Diameter )

63, 100, (2.5", 4" )

#### Scale Range (kgf/cm<sup>2</sup>, psi, bar,)

-1 bar ~ 0 to 0 ~ 400 bar

#### Process Connection

63mm : 1/8", 1/4" BSPT, NPT & BSPF

100mm : 3/8", 1/2" BSPT, NPT & BSPF

Threaded entry - Bottom or Back

#### Blow Protection

Top disc

#### Degree Protection

IP 65

#### Working Pressure

Steady : 75% of Full Scale

Over Range Protection : 130% of Full Scale

#### Working Temperature

Ambient : -20 ~ 65°C

Fluid : Max 80°C

#### Accuracy

± 1.6% of Full Scale

#### Element

SS316 (100 mm)

<100bar : C type Bourdon Tube

>=100bar : Helical Type Bourdon Tube

SS316 (63mm)

<60bar : C type Bourdon Tube

>=60bar : Helical Type Bourdon Tube

#### Material

Case & Cover : Crimped type, SS304

Window : 63mm-PC

: 100mm-Tempered Glass

Connection : SS316

Movement : SS304

Dial Plate : White Aluminum with Black Graduations

Pointer : Aluminium alloy, Black painted

Blowout : NBR

Oil Filling : Glycerin oil/ Silicon oil(option)

### Pressure Gauge Ordering Information

Model	Mounting Type	Dial Size	Range	Unit	Connection	Type
AG54	A : Direct bottom connection	63mm (2.5")	0~1, 0~2, 0~3,	Bar	1/8"	BSPT
AG55	B : Bottom with case surface mounting	100mm(4")	0~4, 0~6, 0~10,	Mpa	1/4"	BSPF
	G : Lower back (100 mm)		0~16, 0~20, 0~25,	Bar & Psi	3/8"	NPT
	F : Center back (63mm)		0~35, 0~40, 0~50,	kgf/cm <sup>2</sup> & Psi	1/2"	
	N : Lower back, flush, cover mounting plate		0~60, 0~70, 0~100,			
			0~160, 0~250, 0~350,			
			0~400, 0~500, 0~600.			

#### Options

Oil Filled

Adjustable Pointer

Damper Movement

Maximum pointer

Red Pointer

#### Example of Order

AG54 \* A \* 4" \* 0~10 Bar&Psi \* 1/2"NPT

## Basic Dimensions

CODE A

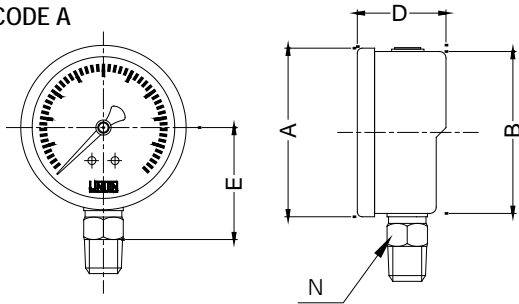

**A: Direct bottom connection**

Unit : mm

	ø 63	ø 100
A	71.0	111.9
B	62.7	103.5
D	36.3	33.2
E	43.0	66.7
N	14.0	22.0

CODE B

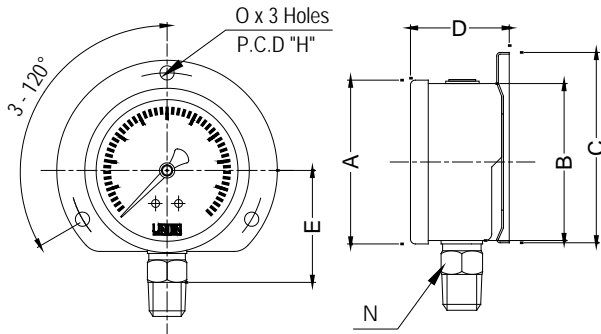

**B: Bottom connection with surface mounting plate**

Unit : mm

	ø 63	ø 100
A	71.0	111.9
B	62.7	103.5
C	79.0	122.0
D	39.2	34.2
E	43.0	66.7
H	78.4	117.5
N	14.0	22.0
O	4.3	6.0

CODE D

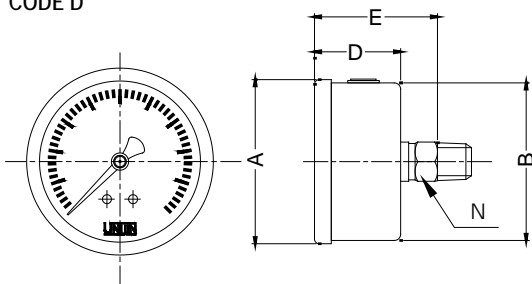

**D: Direct center back connection**

Unit : mm

	ø 63
A	71.0
B	62.7
D	36.0
E	51.0
N	14.0

CODE BD

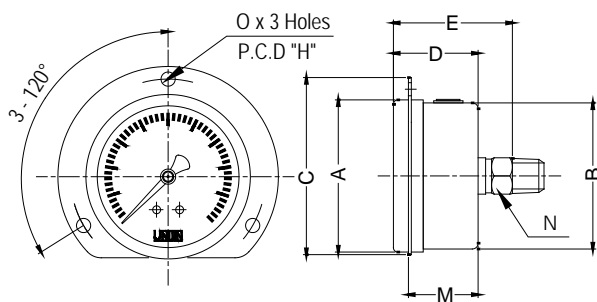

**BD: Center back connection with panel mounting**

Unit : mm

	ø 63
A	71.0
B	62.7
C	87.6
D	36.0
E	51.0
H	78.4
M	26.0
N	14.0
O	4.3

CODE BDC

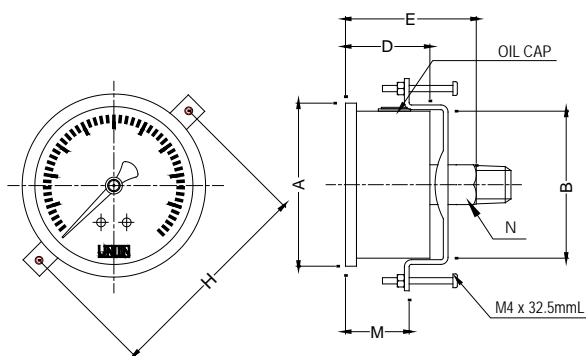

**BDC: Center back connection with clamp**

Unit : mm

	ø 63
A	71.0
B	62.7
D	36.0
E	51.0
H	82.0
M	27.0
N	14.0
O	4.3