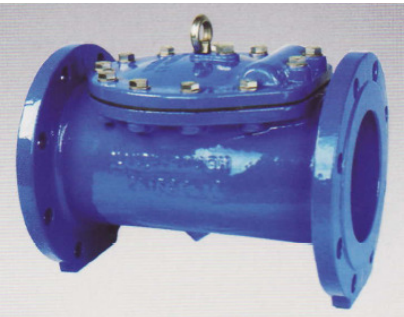

DATA SHEET

FREE ACTING SWING CHECK VALVE

Description	<p>Duvalco check valves are of the Free-Acting Non-Slam design with single or multiple doors, designed to give minimal slam characteristics under all normal pump/flow conditions without the need for external damper or weight systems. These valves rely on the weight of the doors and their setting angle to provide the non-slam characteristics, thus avoiding the need for a shaft to penetrate the pressure housing of the valve body. This reduces the risk of mechanical failure and also of leakage to the exterior of the valve.</p>																						
Size Range	DN150 to DN1000																						
Pressure Rating	All valves are rated at PN16 for 16 bar continuous working pressure <i>(Other pressures also available upon request)</i>																						
Design Standard	BS 5153																						
Materials of Construction	<table border="1" style="width: 100%; border-collapse: collapse;"> <thead> <tr style="background-color: yellow;"> <th>Description</th> <th>Material</th> <th>Standard</th> </tr> </thead> <tbody> <tr> <td>Body</td> <td>Ductile iron</td> <td>BS EN 1563 Grade EN-GJS-400-15</td> </tr> <tr> <td>Disc</td> <td>Ductile iron</td> <td>BS EN 1563 Grade EN-GJS-400-15</td> </tr> <tr> <td>Shaft</td> <td>Stainless steel</td> <td>EN 10088-3 1.4021</td> </tr> <tr> <td>Hinge to Disk connection</td> <td>Gunmetal</td> <td>BS 1400 LG2</td> </tr> <tr> <td>Disk Facing Ring</td> <td>Gunmetal</td> <td>BS 1400 LG2</td> </tr> <tr> <td>Body Seats</td> <td>Gunmetal</td> <td>BS 1400 LG2</td> </tr> </tbody> </table>	Description	Material	Standard	Body	Ductile iron	BS EN 1563 Grade EN-GJS-400-15	Disc	Ductile iron	BS EN 1563 Grade EN-GJS-400-15	Shaft	Stainless steel	EN 10088-3 1.4021	Hinge to Disk connection	Gunmetal	BS 1400 LG2	Disk Facing Ring	Gunmetal	BS 1400 LG2	Body Seats	Gunmetal	BS 1400 LG2	
Description	Material	Standard																					
Body	Ductile iron	BS EN 1563 Grade EN-GJS-400-15																					
Disc	Ductile iron	BS EN 1563 Grade EN-GJS-400-15																					
Shaft	Stainless steel	EN 10088-3 1.4021																					
Hinge to Disk connection	Gunmetal	BS 1400 LG2																					
Disk Facing Ring	Gunmetal	BS 1400 LG2																					
Body Seats	Gunmetal	BS 1400 LG2																					
Testing	<p>All valves are works tested to the following pressures:-</p> <table border="1" style="width: 100%; border-collapse: collapse;"> <thead> <tr style="background-color: yellow;"> <th>Description</th> <th>Nominal Pressure</th> <th>Hydraulic Test Pressure</th> </tr> </thead> <tbody> <tr> <td>Body</td> <td>16 bar</td> <td>24 bar</td> </tr> <tr> <td>Seat</td> <td>16 bar</td> <td>17.6 bar</td> </tr> </tbody> </table>	Description	Nominal Pressure	Hydraulic Test Pressure	Body	16 bar	24 bar	Seat	16 bar	17.6 bar													
Description	Nominal Pressure	Hydraulic Test Pressure																					
Body	16 bar	24 bar																					
Seat	16 bar	17.6 bar																					
Corrosion Protection	<ol style="list-style-type: none"> 1) All internal and external cast surfaces are coated with fusion bonded powder epoxy. 2) Epoxy coating is WRAS listed for potable water applications and meets the requirements of BS 6920 for water quality testing. 3) Coating colour - blue to RAL 5005 																						

DATA SHEET

FREE ACTING SWING CHECK VALVE

Dimensional Details

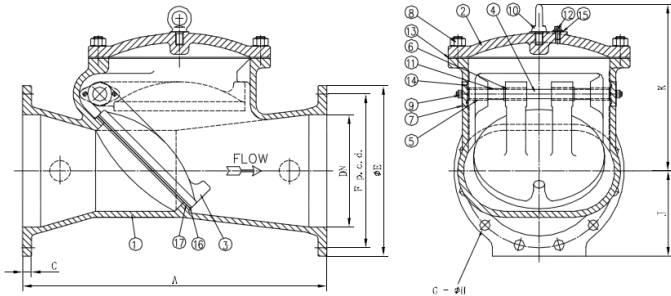

DN	A	C	ØE	F p. c. d.	G - ØH	I	K
150	508	19	285	235	8-Ø22.2	142.5	285
200	610	20	340	292.1	8-Ø22.2	170	335
250	711	21	400	355.6	12-Ø22.2	200	365
300	813	24.5	455	406.4	12-Ø25.4	227.5	443
350	889	26.5	520	469.9	12-Ø25.4	260	488
400	965	28	580	520.7	12-Ø25.4	290	537
450	1016	30	640	584.2	12-Ø25.4	320	569

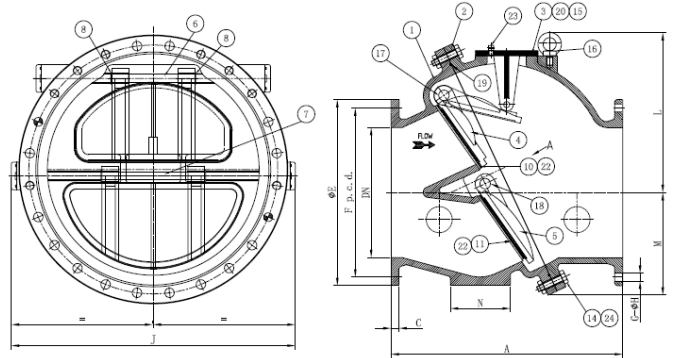

DN	A	C	ØE	M	L	J	N	F p.c.d.	G-ØH
500	890	30.5	715	406	613	1128	230	641.4	16-Ø25.4
600	920	34	840	451	673	1226	230	755.7	16-Ø31.8
900	1190	44.5	1125	635	936	1551	270	1092.2	24-Ø35

Face-to-face length

According to manufacturer's standards.

Flange Drilling

Flanges for pipe connection are compatible with flanges to EN 1092-2 up to PN16.

Alternatively, flanges to other standards, including BS10 Table E can be supplied.

*Note

Please refer to the General Arrangement drawing for full details of the valves.

Marking	<p>All valves are marked with the following information:-</p> <ul style="list-style-type: none"> - Class - Size - PN rating - 'Duvalco' - Material - SG / GGG50 - BS 5153 - Year of manufacture
Packing	<p>All valves will be despatched properly packed, with all items separated to avoid damage to coating, castings, facings, flange faces, etc.</p>