

3-way Ball Valve

AT612 - SUS304 A351Gr CF8 - ANSI-150LB
 AT613 - SUS316 A351Gr CF8M - ANSI-150LB

FEATURES:

- END FLANGE DIMENSION: ANSI B16.5
- TEST: ANSI B16.34
- INVESTMENT CASTING BODY
- WITH ISO 5211 MOUNTING PAD
- LOCKING DEVICE
- THERE ARE FOUR SEATS
- L-PORT OR T-PORT AVAILABLE / 360°PAD

MATERIALS LIST:

NO.	PART NAME	MATERIAL	
1	BODY	CF8M	CF8
2	CAP	CF8M	CF8
3	BALL	CF8M	CF8
4	SEAT	PTFE	
5	STEM	SUS316	SUS304
6	GASKET	PTFE	
7	THRUST WASHER	15%R+PTFE	
8	O-RING	VITON	
9	PACKING	PTFE	
10	GLAND	SUS304	
11	SPRING WASHER	SUS304	
12	STEM NUT	SUS304	
13	STOP WASHER	SUS304	
14	HANDLE WASHER	SUS304	
15	LOCKING DEVICE	SUS304	
16	HANDLE	SUS304	
17	PLASTIC COVER	PLASTIC	
18	CAP-A	CF8M	CF8
19	BOLT	SUS304	
20	STOP PIN	SUS304	
21	BOLT	SUS304	
22	NUT	SUS304	

FLOW PATTERN:

PORT TYPE	1	2	3	4
L	1 ⊕ 2 3	1 ⊕ 2 3	1 ⊕ 2 3	1 ⊕ 2 3
T	1 ⊕ 2 3	1 ⊕ 2 3	1 ⊕ 2 3	1 ⊕ 2 3

TEST PRESSURE:

SHELL(BY WATER)	450PSI
	32kg/cm ²
SEAT	BY WATER
	315PSI
	22kg/cm ²
	BY AIR
85PSI	
6kg/cm ²	

DIMENSIONS:

SIZE		d	D	C	G	T	f	N	M	L	H	W	ISO 5211	E	H1	W1	Ra	Rb
DN	NPS																	
15	1/2"	15	89	60.5	35	12.1	1.6	4	16	148	80	123	F03-F04	36-42	9	9	R3	R3
20	3/4"	20	98	70.0	43	12.1	1.6	4	16	153	84	123	F03-F04	36-42	9	9	R3	R3
25	1"	25	108	79.5	51	12.1	1.6	4	16	168	96	153	F04-F05	42-50	11	11	R3	R3.5

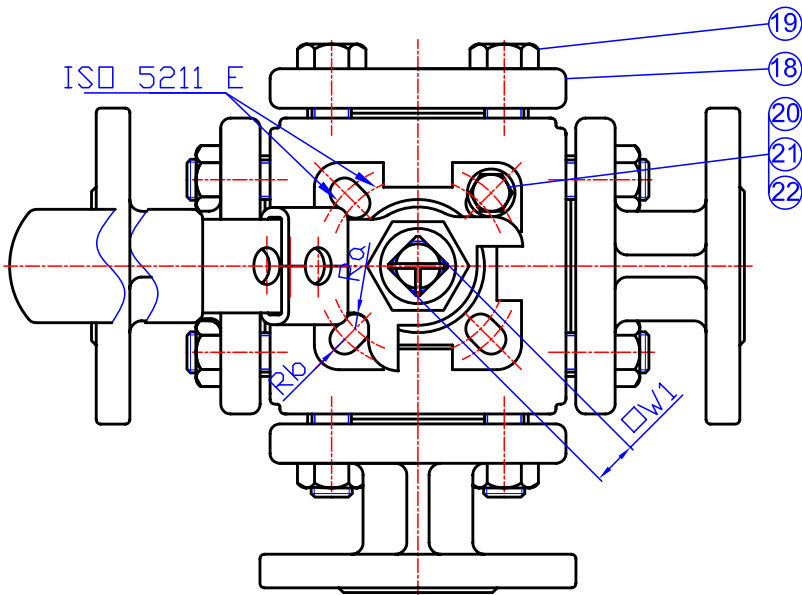
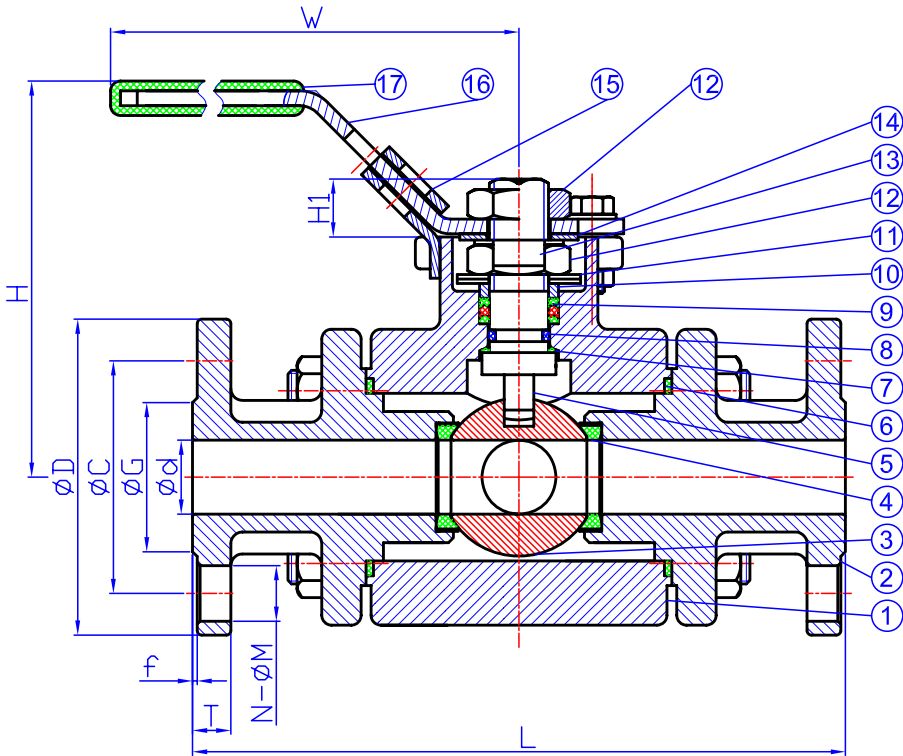

3-way Ball Valve

AT612 - SUS304 A351Gr CF8 - ANSI-150LB
 AT613 - SUS316 A351Gr CF8M - ANSI-150LB

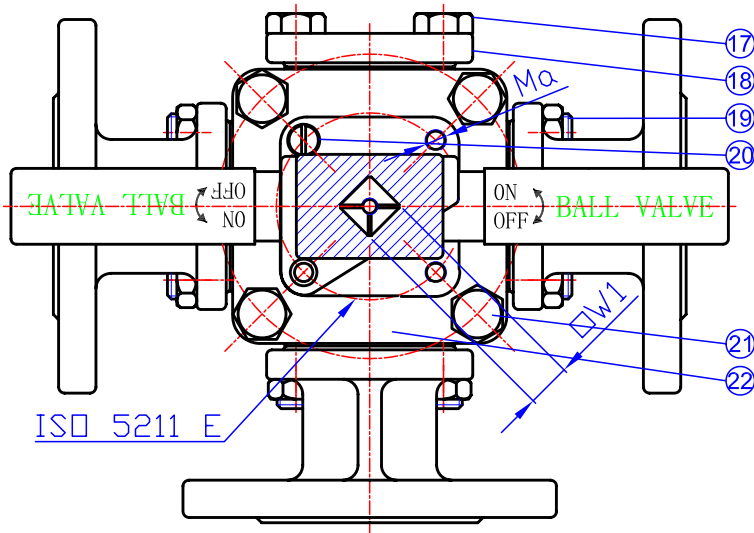
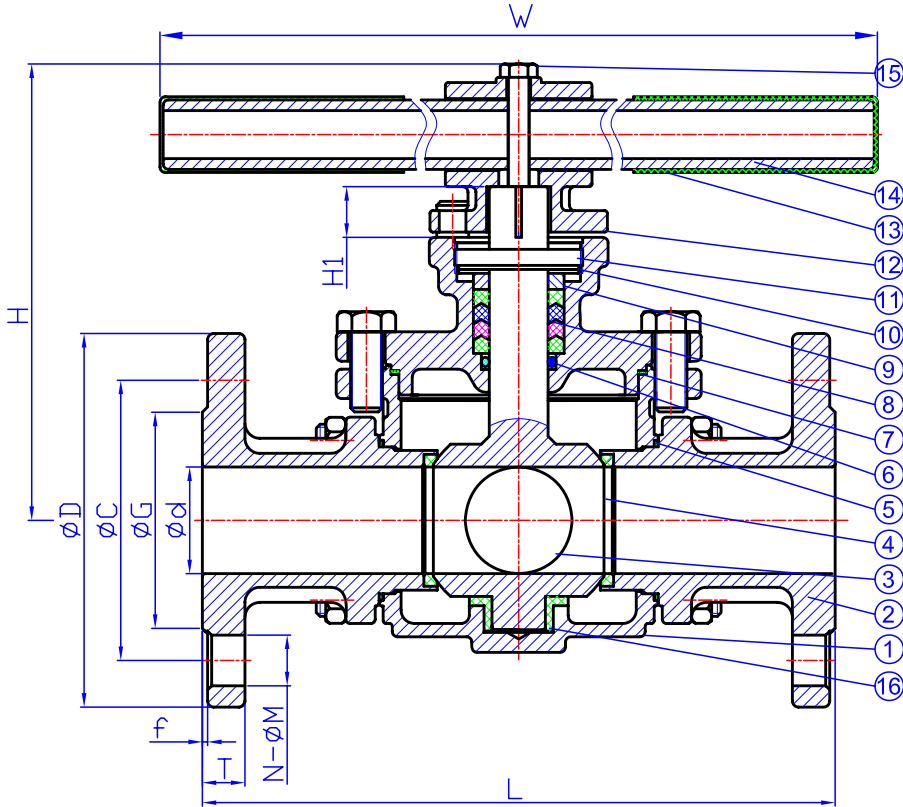

FEATURES:

- END FLANGE DIMENSION: ANSI B16.5
- TEST: ANSI B16.34
- INVESTMENT CASTING BODY
- FIXED BALL / FULL PORT
- WITH ISO 5211 MOUNTING PAD
- THERE ARE FOUR SEATS
- L-PORT OR T-PORT AVAILABLE / 360°PAD

MATERIALS LIST:

NO.	PART NAME	MATERIAL	
1	BODY	CF8M	CF8
2	CAP	CF8M	CF8
3	BALL	CF8M	CF8
4	SEAT	PTFE	
5	GASKET	PTFE	
6	O-RING	VITON	
7	GASKET	PTFE	
8	PACKING	PTFE	
9	GLAND	SUS304	
10	SPRING WASHER	SUS304	
11	CAP-C	CF8M	CF8
12	HANDLE HEAD	CF8	
13	PLASTIC COVER	PLASTIC	
14	HANDLE POLE	SUS304	
15	HANDLE BOLT	SUS304	
16	SLEEVE	PTFE	
17	CAP-B BOLT	SUS304	
18	CAP-B	CF8M	CF8
19	BOLT	SUS304	
20	STOP PIN	SUS304	
21	CAP-A BOLT	SUS304	
22	CAP-A	CF8M	CF8

FLOW PATTERN:

PORT TYPE	1	2	3	4
L	1 ⊕ 2 3	1 ⊕ 2 3	1 ⊕ 2 3	1 ⊕ 2 3
T	1 ⊕ 2 3	1 ⊕ 2 3	1 ⊕ 2 3	1 ⊕ 2 3

TEST PRESSURE:

SHELL(BY WATER)	450PSI
	32kg/cm ²
	315PSI
	22kg/cm ²
SEAT	BY WATER
	BY AIR
	85PSI
	6kg/cm ²

DIMENSIONS:

SIZE		d	D	C	G	T	f	N	M	L	H	W	ISO 5211	E	H1	W1	Ma
DN	NPS																
40	1 1/2"	40	127	98.5	73	14.3	1.6	4	16	221	171	403	F07	70	19	17	M8
50	2"	50	152	120.5	92	15.9	1.6	4	19	254	176	403	F07	70	19	17	M8
65	2 1/2"	65	178	139.5	105	17.5	1.6	4	19	300	198	504	F10	102	24	22	M10
80	3"	76	190	152.5	127	19.1	1.6	4	19	305	216	504	F10	102	24	22	M10
100	4"	96	229	190.5	157	23.9	1.6	8	19	369	236	504	F10	102	24	22	M10
150	6"	148	279	241.5	216	25.4	1.6	8	22	480	329	800	F14	140	38	36	M16

