

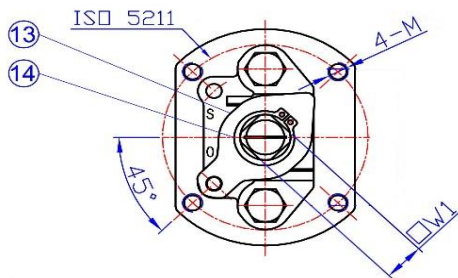

SPECIFICATION:

- Full bore ball valve
- Investment casting body
- Blow-out-proof stem
- Dimensions according to ANSI B16.5 B16.10
- Pressure test according to API 598
- Design according to ANSI B16.34
- ISO5211 mounting pad
- Working temperature up to 180° C

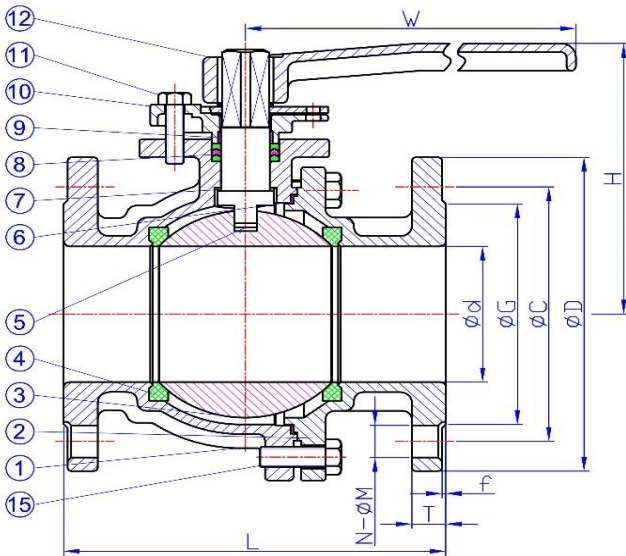

PRESSURE TEST

SHELL	SEAT	
	by water	by air
450 psi	315 psi	85 psi

MATERIAL LIST

NO.	PART NAME	MATERIAL		
		AT226	AT227	AT228
1	Body	WCB	CF8	CF8M
2	Cap	WCB	CF8	CF8M
3	Ball	CF8	CF8	CF8M
4	Seat	R-PTFE	R-PTFE	
5	Stem	SUS304	SUS304	SUS316
6	Gasket	PTFE	PTFE	
7	Thrust Washer	PTFE	PTFE	
8	Packing	PTFE	PTFE	
9	Stem Packing	PTFE	PTFE	
10	Gland	CF8	CF8	
11	Gland Bolt	B7	SUS304	
12	Handle	WCB	WCB	
13	Stopper	SUS304	SUS304	
14	Snap Ring	SUS304	SUS304	
15	Bolt	B7	SUS304	

DIMENSIONS

SIZE	ø d	L	H	W	FLANGE ANSI-150LB						TOP MOUNTING		
					ø C	ø D	ø G	f	T	N-øM	ISO5211	W1	4-M
1/2"	15	108	70	160	60.5	89	35	1.6	11.1	4 - ø16	F04	12	M5
3/4"	20	117	73	160	70.0	98	43	1.6	11.1	4 - ø16	F04	12	M5
1"	25	127	77	160	79.5	108	51	1.6	11.1	4 - ø16	F05	12	M6
1-1/4"	32	140	85	160	89.5	117	64	1.6	12.7	4 - ø16	F05	12	M6
1-1/2"	40	165	104	186	98.5	127	73	1.6	14.3	4 - ø16	F07	17	M8
2"	50	178	114	186	120.5	152	92	1.6	15.9	4 - ø19	F07	17	M8
2-1/2"	65	190	142	324	139.5	178	102	1.6	17.5	4 - ø19	F07	21	M8
3"	80	203	153	324	152.5	190	127	1.6	19.1	4 - ø19	F10	21	M10
4"	100	229	166	324	190.5	229	157	1.6	23.9	8 - ø19	F10	21	M10
5"	125	356	224	750	216.0	254	186	1.6	23.9	8 - ø22	F12	24	M12
6"	150	394	247	750	241.5	279	216	1.6	25.4	8 - ø22	F12	24	M12
8"	200	457	305	1000	298.5	343	270	1.6	28.6	8 - ø22	F12	32	M12
10"	250	533	327	1000	362.0	406	324	1.6	30.2	12 - ø25	F14	32	M16
12"	300	610	355	1000	432.0	483	381	1.6	31.8	12 - ø25	F14	32	M16

The specification and dimensions are subject to change without prior notice!