

3-way Ball Valve

AT610 - SUS304 A351Gr SCS13 - JIS-10K
 AT611 - SUS316 A351Gr SCS14 - JIS-10K

FEATURES:

- END FLANGE DIMENSION: JIS B2239
- TEST: JIS B2003
- INVESTMENT CASTING BODY
- WITH ISO 5211 MOUNTING PAD
- LOCKING DEVICE
- THERE ARE FOUR SEATS
- L-PORT OR T-PORT AVAILABLE / 360°PAD

MATERIALS LIST:

NO.	PART NAME	MATERIAL	
1	BODY	SCS14	SCS13
2	CAP	SCS14	SCS13
3	BALL	SCS14	SCS13
4	SEAT	PTFE	
5	STEM	SUS316	SUS304
6	GASKET	PTFE	
7	THRUST WASHER	15%R+PTFE	
8	O-RING	VITON	
9	PACKING	PTFE	
10	GLAND	SUS304	
11	SPRING WASHER	SUS304	
12	STEM NUT	SUS304	
13	STOP WASHER	SUS304	
14	HANDLE WASHER	SUS304	
15	LOCKING DEVICE	SUS304	
16	HANDLE	SUS304	
17	PLASTIC COVER	PLASTIC	
18	CAP-A	SCS14	SCS13
19	BOLT	SUS304	
20	STOP PIN	SUS304	
21	BOLT	SUS304	
22	NUT	SUS304	

FLOW PATTERN:

PORT TYPE	1	2	3	4
L	1 2 3	1 2 3	1 2 3	1 2 3
T	1 2 3	1 2 3	1 2 3	1 2 3

TEST PRESSURE:

SHELL(BY WATER)	2.1 MPa
	21.5kg/cm ²
SEAT	BY WATER
	BY AIR
	1.6 MPa
	16.5kg/cm ²
	0.6 MPa
	6kg/cm ²

DIMENSIONS:

SIZE		d	D	C	G	T	f	N	M	L	H	W	ISO 5211	E	H1	W1	Ra	Rb
DN	NPS																	
15	1/2"	15	95	70	51	12	1	4	15	160	80	123	F03-F04	36-42	9	9	R3	R3
20	3/4"	20	100	75	56	14	1	4	15	165	84	123	F03-F04	36-42	9	9	R3	R3
25	1"	25	125	90	67	14	1	4	19	180	96	153	F04-F05	42-50	11	11	R3	R3.5

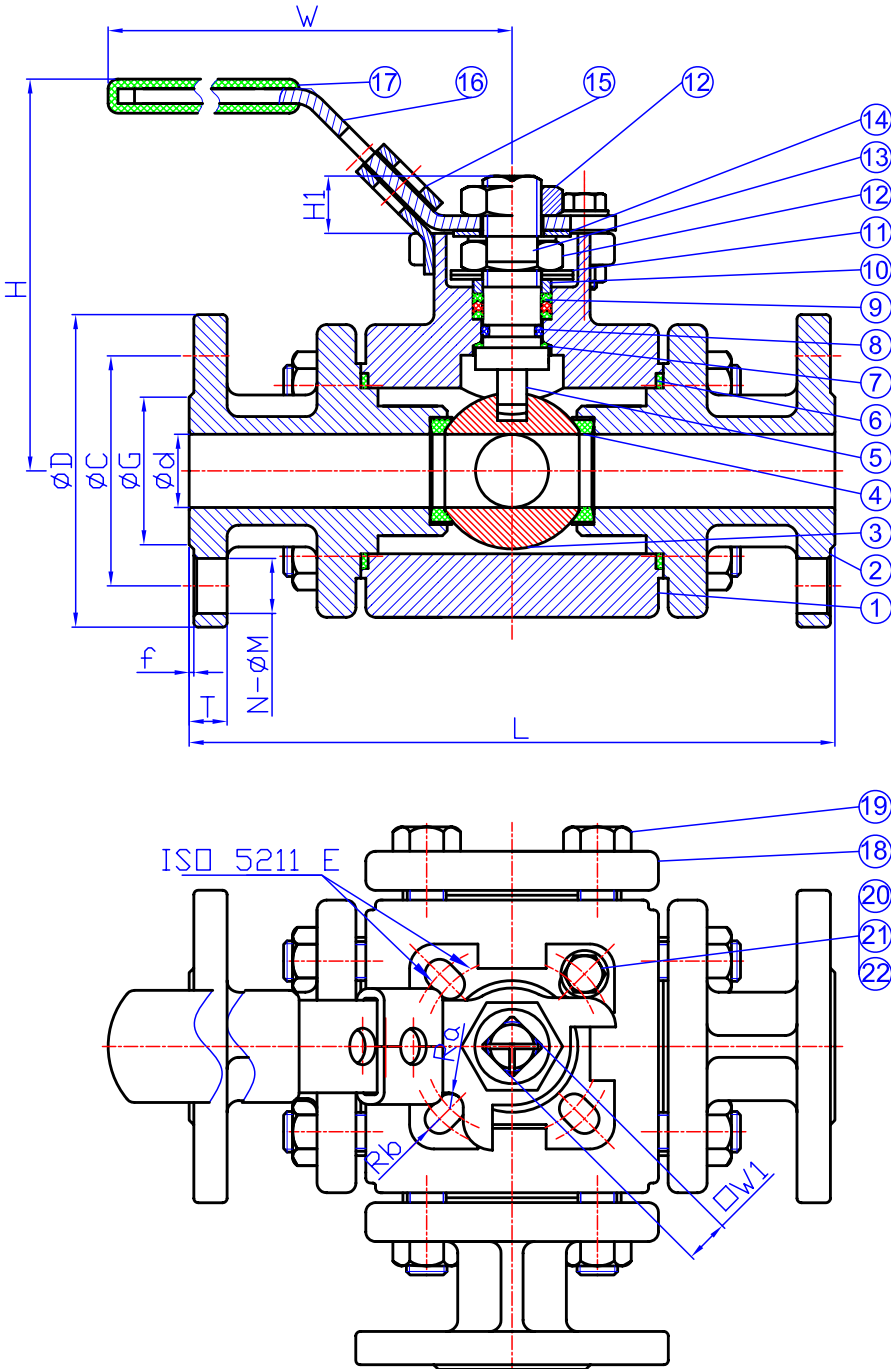

3-way Ball Valve

AT610 - SUS304 A351Gr SCS13 - JIS-10K
 AT611 - SUS316 A351Gr SCS14 - JIS-10K

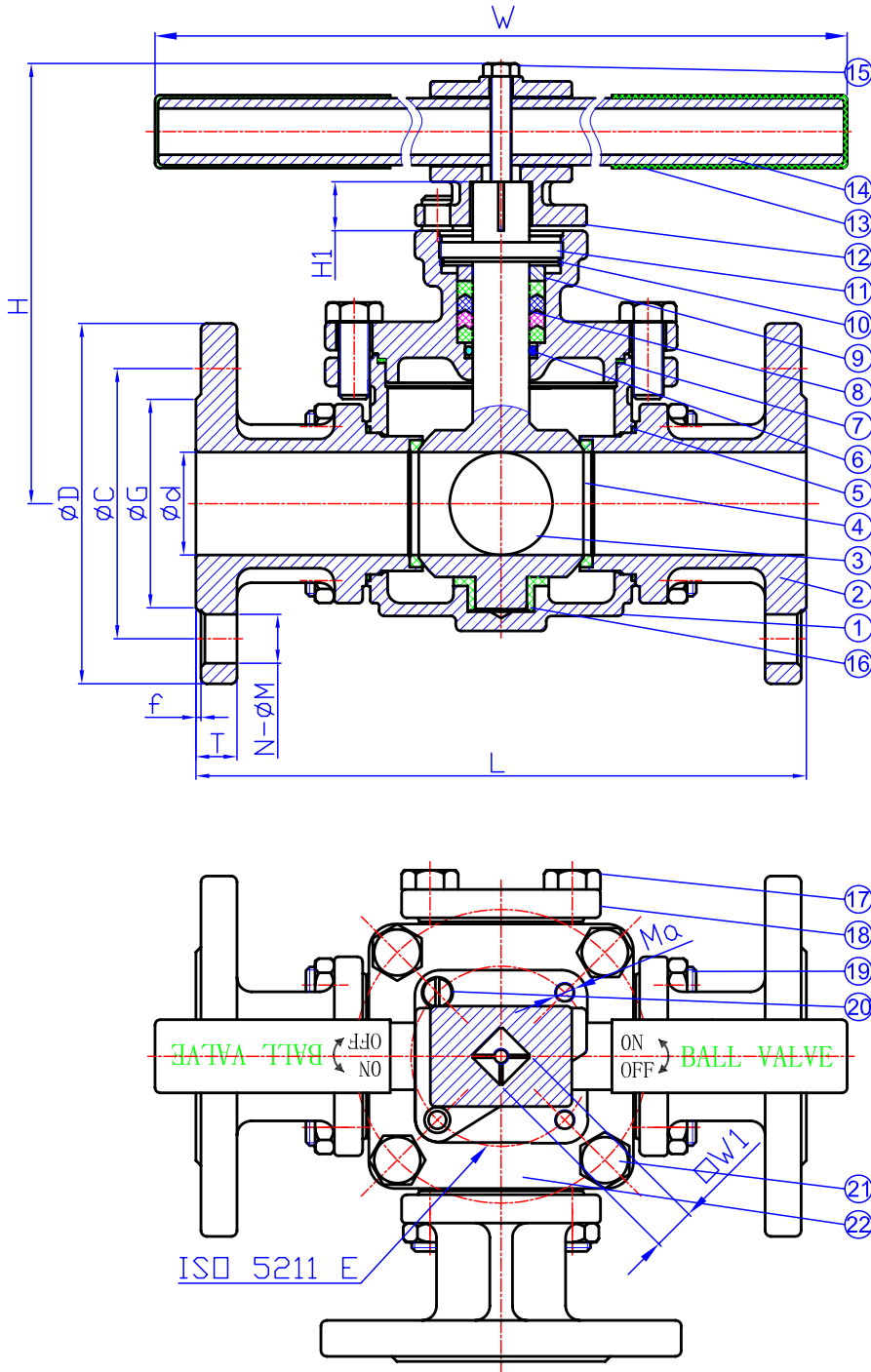

FEATURES:

- END FLANGE DIMENSION: JIS B2239
- TEST: JIS B2003
- INVESTMENT CASTING BODY
- FIXED BALL / FULL PORT
- WITH ISO 5211 MOUNTING PAD
- THERE ARE FOUR SEATS
- L-PORT OR T-PORT AVAILABLE / 360°PAD

MATERIALS LIST:

NO.	PART NAME	MATERIAL	
1	BODY	SCS14	SCS13
2	CAP	SCS14	SCS13
3	BALL	SCS14	SCS13
4	SEAT	PTFE	
5	GASKET	PTFE	
6	O-RING	VITON	
7	GASKET	PTFE	
8	PACKING	PTFE	
9	GLAND	SUS304	
10	SPRING WASHER	SUS304	
11	CAP-C	SCS14	SCS13
12	HANDLE HEAD	CF8	
13	PLASTIC COVER	PLASTIC	
14	HANDLE POLE	SUS304	
15	HANDLE BOLT	SUS304	
16	SLEEVE	PTFE	
17	CAP-B BOLT	SUS304	
18	CAP-B	SCS14	SCS13
19	BOLT	SUS304	
20	STOP PIN	SUS304	
21	CAP-A BOLT	SUS304	
22	CAP-A	SCS14	SCS13

FLOW PATTERN:

PORT TYPE	1	2	3	4
L	1 2 3 3	1 2 3 3	1 2 3 3	1 2 3 3
T	1 2 3 3	1 2 3 3	1 2 3 3	1 2 3 3

TEST PRESSURE:

SHELL(BY WATER)	2.1 MPa
	21.5kg/cm ²
SEAT	BY WATER 1.6 MPa
	16.5kg/cm ²
BY AIR	0.6 MPa
	6kg/cm ²

DIMENSIONS:

SIZE	d	D	C	G	T	f	N	M	L	H	W	ISO 5211	E	H1	W1	Ma
DN/NPS																
40 1 1/2"	40	140	105	81	16	2	4	19	221	171	403	F07	70	19	17	M8
50 2"	50	155	120	96	16	2	4	19	254	176	403	F07	70	19	17	M8
65 2 1/2"	65	175	140	116	18	2	4	19	300	198	504	F10	102	24	22	M10
80 3"	76	185	150	126	18	2	8	19	305	216	504	F10	102	24	22	M10
100 4"	96	210	175	151	18	2	8	19	369	236	504	F10	102	24	22	M10
150 6"	148	280	240	212	22	2	8	23	480	329	800	F14	140	38	36	M16

